

Vent Hood® WALL MOUNT RANGE HOOD SPECIFICATIONS

CWLH9 Equipped with halogen lighting. These models not available with heat lamps. Shown with optional duct cover (sold separately). Optional duct covers are available in standard and custom sizes (sold separately). Galley rail included.

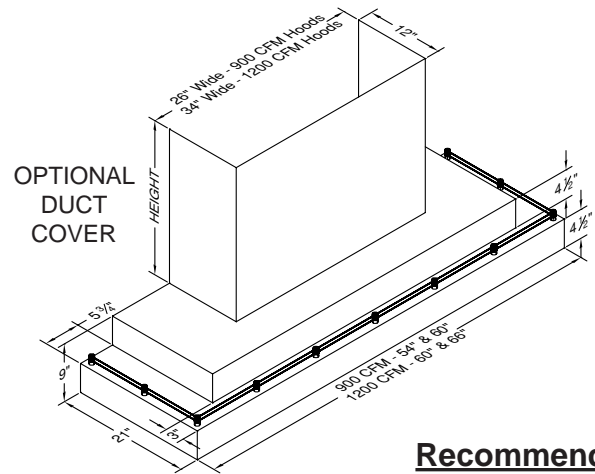

Connection Diagram (30" - 48" Widths)

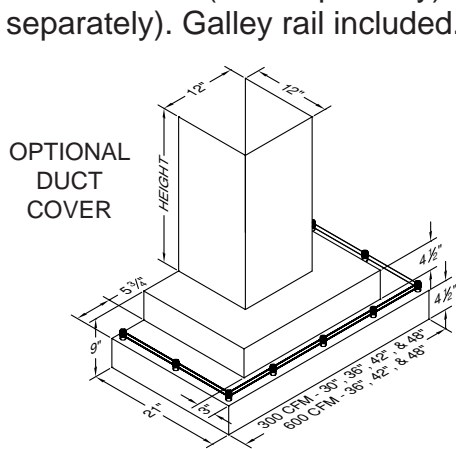
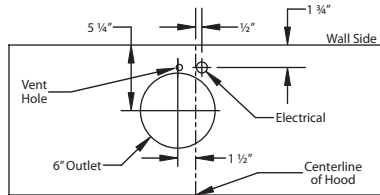

300 CFM B100 Single Blower (Top View)

Connection Diagram (36" - 48" Widths)

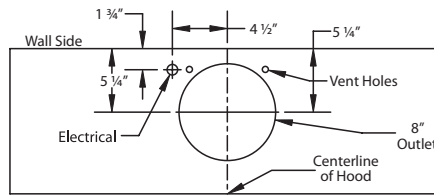

600 CFM B200 Dual Blower (Top View)

Recommended Mounting Height*

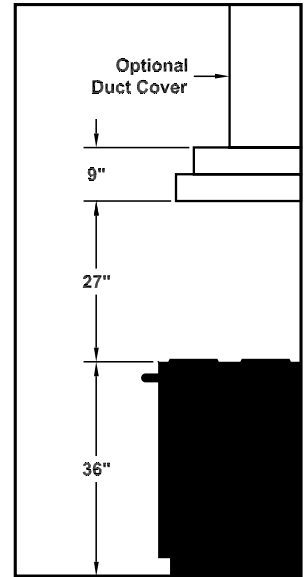

*Exceeding recommended mounting height may compromise performance.

Connection Diagram (54" - 60" Widths)

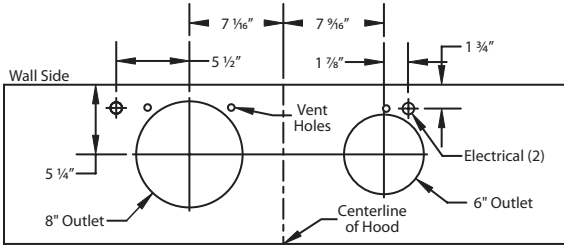

900 CFM B200 Dual & B100 Single Blower (Top View)

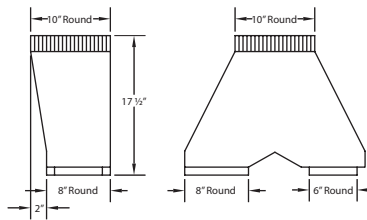

VP562 Transition (Optional) for B300 (B200 Dual & B100 Single Blower)

Connection Diagram (60" - 66" Widths)

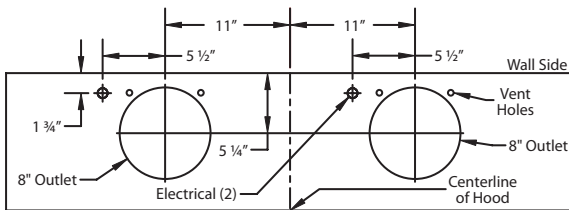

1200 CFM Double B200 Dual Blowers (Top View)

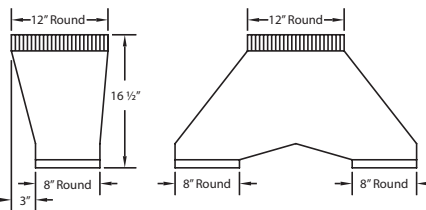

VP563 Transition (Optional) for B400 (For Double B200 Dual Blowers)

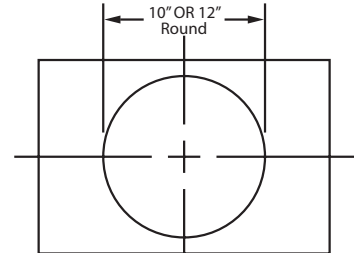

VP562/VP563 transition centers outlet over top of hood

Electrical/Mechanical Specifications For Blower Units

| Model | Volts | Amps* | Hz | RPM | CFM SP@0.0" | Equivalent CFM* | CFM SP@0.1" | CFM SP@0.2" | CFM SP@0.3" | Minimum Round Duct Size | Sones# |
|-------------------------|-------|-------|----|------|-------------|-----------------|-------------|-------------|-------------|------------------------------------|--------|
| B100 Single | 115 | 1.5 | 60 | 1550 | 300 | 450 | 273 | 245 | 225 | 6" (28 in. ²) | 5.4 |
| B200 Dual | 115 | 2.9 | 60 | 1550 | 600 | 900 | 531 | 480 | 430 | 8" (50 in. ²) | 6.5 |
| B200 Dual & B100 Single | 115 | 4.4 | 60 | 1550 | 900 | 1350 | 804 | 725 | 655 | VP562: 10" (79 in. ²) | 6.3 |
| Two B200 Duals | 115 | 5.8 | 60 | 1550 | 1200 | 1800 | 1062 | 960 | 860 | VP563: 12" (113 in. ²) | 6.6 |

* Add 0.5 amp for each halogen light. Hood is available with halogen lights (2 lights: 30" - 41"; 3 lights: 42" - 53"; 4 lights: 54" - 66"; +1 light for each 14" if over 66").
 # Because the Magic Lung® blower uses centrifugal filtration rather than conventional baffle or mesh filters, the Magic Lung® blower can handle cooking equipment with higher cubic feet per minute (CFM) requirements and can deliver equivalent CFM much more efficiently than other than other filtration systems. When comparing the Magic Lung® with other blower units made by other manufacturers, use the "Equivalent CFM".
 # Ratings in accordance with the Standard Test Code by the Energy Systems Laboratory of the Texas Engineering Experiment Station.

